

**STORAGE**

- ✓ Columns and capitals should be stored in an area that is cool, dry, well ventilated and out of direct sunlight.

**PREPARATION**

- ✓ Decorative capitals are supplied from both load bearing and non-load bearing materials. Decorative capitals manufactured from non-load bearing materials, such as plaster, are shipped with a wood plug to support the load.

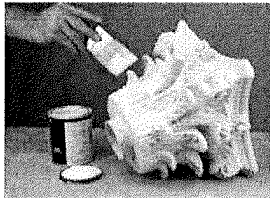

All decorative capitals must be primed with one (1) coat of an exterior oil-based primer and then painted with one (1) coat of exterior oil-based paint. All surfaces, including the top and bottom of the decorative capital must be coated. Apply the coatings with a brush to best protect the column from moisture. Follow the paint manufacturer's instructions for best results.

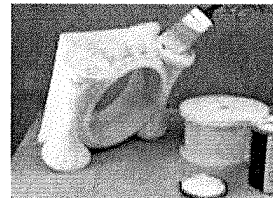

**NOTE: Plaster decorative capitals must be coated IMMEDIATELY upon receipt to prevent damage from moisture.**

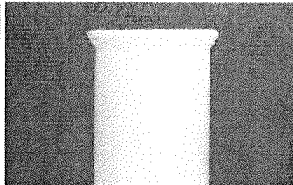

- ✓ Decorative capitals are designed to be installed with columns that are trimmed flush above the bead. Columns may be ordered from the factory already cut at the bead, or may be trimmed at the job-site. **NOTE: An abrasive cut-off blade should be used for fiberglass columns.**
- ✓ Always review the cut at bead loss and the decorative capital height when selecting the column length. Shorter decorative capitals may require the selection of longer shafts.

**LOAD BEARING**

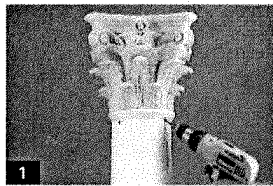

**1.** Center the decorative capital on top of the shaft. Pre-drill and countersink holes through the shaft into the decorative capital. Attach the decorative capital to the shaft with rust resistant screws.



**2.** Place the assembled capital shaft in the proper position under the soffit. Pre-drill and countersink holes through the soffit at an angle into the capital. Secure the capital to the soffit with rust resistant screws.



**3.** Interior installations require shims to secure the capital in position under the soffit.

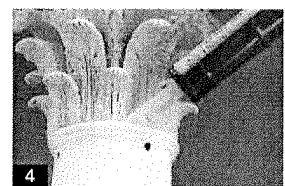

**4.** Apply paintable silicone sealant to the joint between the shaft and capital and between the soffit and capital.

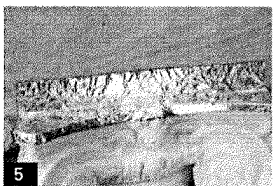

**5.** Install flashing on the side of the soffit and capital that is exposed to the elements.

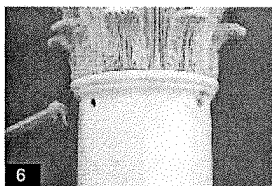

**6.** Fill holes in fiberglass with automotive body filler. Holes in wood are covered with wood filler and sanded smooth. Finish the column by applying a final coat of exterior oil-based paint.

NON-LOAD BEARING

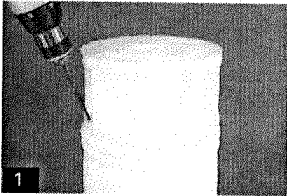

1. Center the primed and painted wood plug over the shaft. Install the wood plug to the shaft with rust resistant screws.

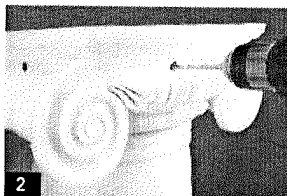

2. Place the decorative capital over the wood plug. Secure by pre-drilling and countersinking pilot holes through the decorative capital into the wood plug.

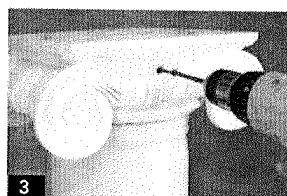

3. Install rust resistant screws to mount the capital to the plug. Use caution and do not over tighten screws as damage to the capital may occur.

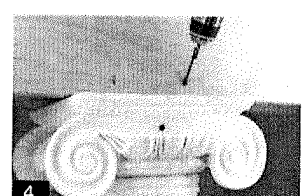

4. Place the assembled capital and shaft in the proper position under the soffit. Lower the soffit onto the wood plug **insuring that no weight rests on the decorative capital.** Pre-drill and countersink holes through the soffit at an angle into the wood plug. Interior installations require shims to secure the capital in position under the soffit. Secure the wood plug to the soffit with rust resistant screws.

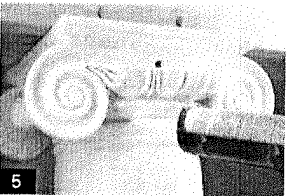

5. Apply paintable silicone sealant to the joint between the shaft and capital and between the soffit and capital.

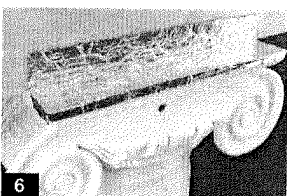

6. Install flashing to prevent decay of the decorative capital. The flashing is installed on the side of the soffit and capital that is exposed to the elements. The flashing begins 1" from the bottom of the soffit and continues down to the capital, turns across the top of the capital and folds over 1/2" down the top edge of the capital. Trim away any excess flashing. Flashing is required on two sides of the soffit and capital exposed to the elements when a column is installed at a corner.

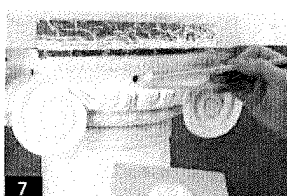

7. Fill holes in plaster with automotive body filler. Holes in wood are covered with wood filler and sanded smooth. Finish the column by applying a final coat of exterior oil-based paint.